

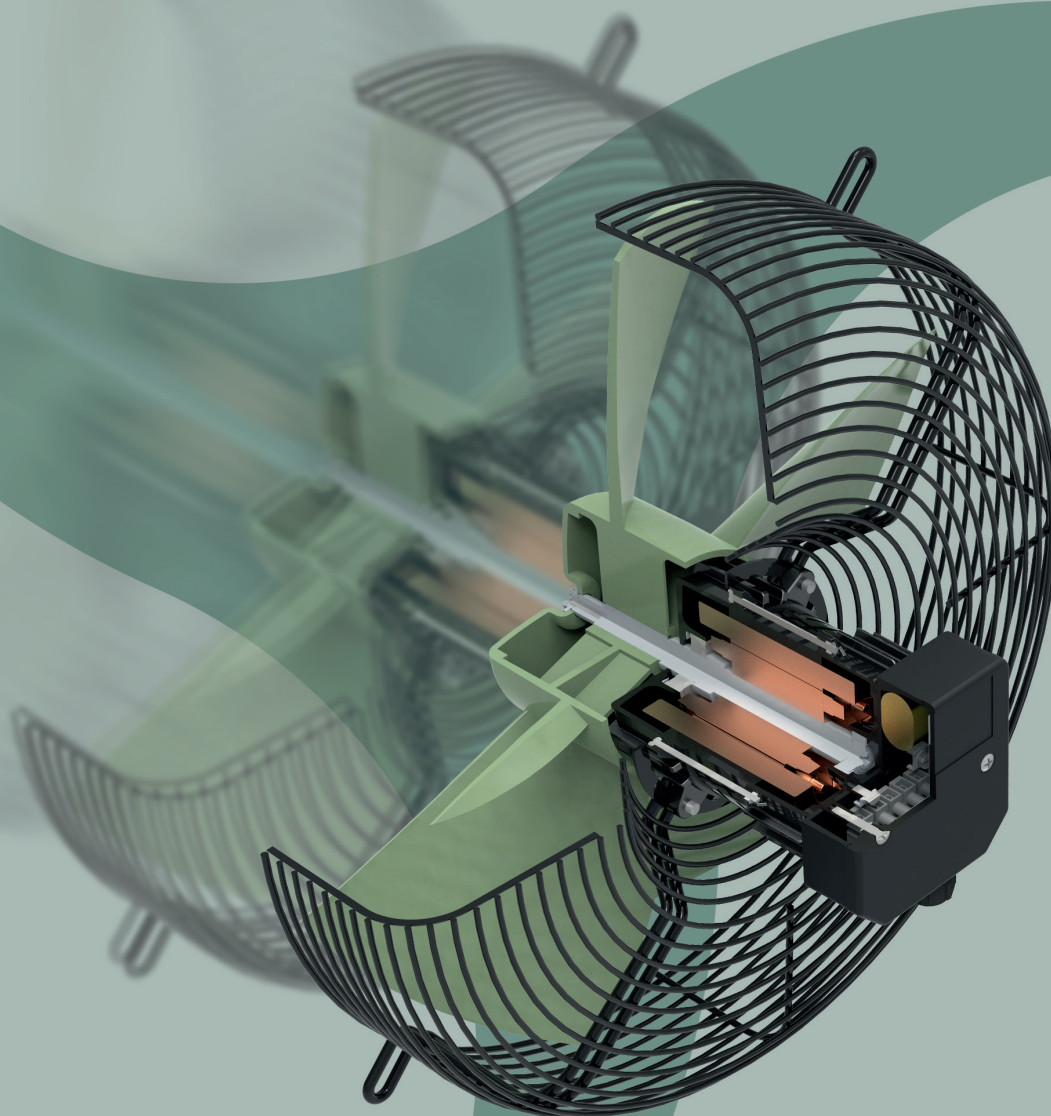

SOVATEC



PRODUCT RANGE

INTRODUCTION



SOVATEC HIGH EFFICIENCY FANS

**“WHERE QUALITY RULES,
WE ARE NOT AFRAID OF
ANY MARKET LEADER!”**

SOVATEC Produktions GmbH designs and produces electric motors and axial fans according to high quality standards.

Whether you are planning a new ventilation concept, or looking for a replacement for existing hardware, our ventilation system provides customized solutions to your needs, by combining ventilation- and drive technology.

SOVATEC product range provides cost efficient, adaptable systems and fulfills national and international requirements (e.g. ErP, CE, UL, ...). Our worldwide operating team is looking forward to support you with fast solutions to your ventilation and drive technology requirements.

We develop electronic motors in AC, DC and EC configuration.

Applying a system of continuous product improvement, SOVATEC is dedicated to generating the best customer value in our Austrian production facility, where a high degree of automation and state of the art measurement- and testing equipment ensures a highly competitive manufacturing process.

EFFICIENCY & QUALITY

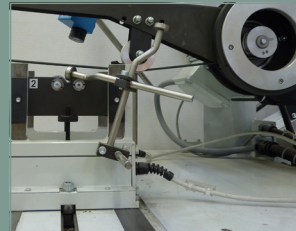
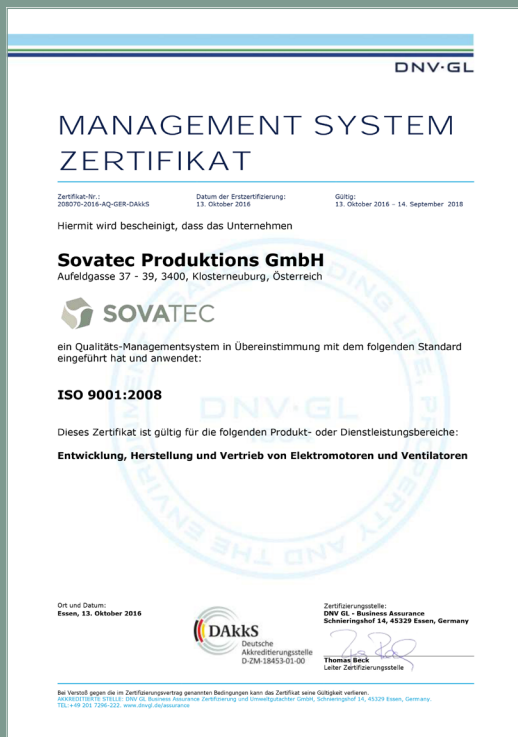

GUARANTEED

The product range is continuously being expanded according to our own research and development. Performance data of all model ranges is verified and recorded under realistic conditions instead of in idealized laboratory environments.

Our MED range offers best price-performance ratio. The fans consist of an electric motor and fan blades with diameters between 250mm and 500mm of durable metal. The drives are single phase or three phase external rotor systems. The MED range is characterized by a particularly compact design. It is a convenient solution for a diverse field of applications. Special designs for individual requirements are possible.



MED SERIES

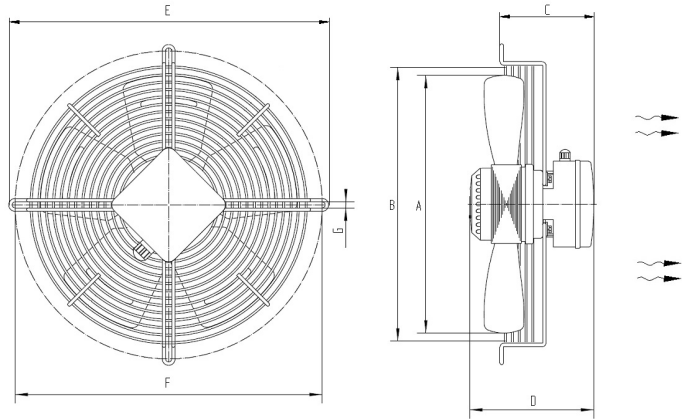

DIMENSION CHART [inch]

	A	B	C	D	E	F	G
MED2-025-A025E2UL-BBC	9.84	10.83	4.57	5.38	13.18	12.60	0.28
MED2-025-A025E4UL-BBC	9.85	10.84	4.57	5.38	13.18	12.60	0.28
MED2-030-A035E2UL-BBC	11.81	12.60	4.33	5.75	14.75	14.17	0.28
MED2-030-A035E4UL-BBC	11.81	12.60	4.33	5.75	14.75	14.17	0.28
MED2-031-A035E4UL-BBC	12.40	13.19	4.33	5.75	15.95	15.35	0.28
MED2-035-B034E4UL-BBC	13.78	14.57	4.53	6.66	17.36	16.61	0.37
MED2-040-B047D4UL-BBC	15.75	16.54	4.92	7.16	19.33	18.5	0.37
MED2-040-B047E4UL-BBC	15.75	16.54	4.92	7.16	19.33	18.5	0.37
MED2-045-B060D4UL-BBC	17.72	18.50	4.92	7.67	21.39	20.55	0.37
MED2-045-B060E4UL-BBC	17.72	18.50	4.92	7.67	21.39	20.55	0.37
MED2-050-C035D4UL-BBC	19.69	20.47	4.96	7.24	25.48	24.61	0.41
MED2-050-C035E4UL-BBC	19.69	20.47	4.96	7.24	25.48	24.61	0.41

OPTIONS



RANGE OF MOUNTING POSSIBILITIES



VARIOUS PROTECTION GRIDS

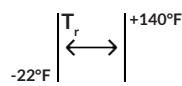

Copyright Sovatec Produktions GmbH. This data sheet shows a technical overview of our products. Please contact us if more detailed information is needed. As we are constantly improving our products, their characteristics, dimensions and weights may also change, although we do our best to incorporate these changes continually. The information in this data sheet is intended to be used as a first general guideline only. Sovatec assumes no liability for any information therein, any errors, omissions, misprints, nor any direct or indirect damages, losses or costs resulting therefrom. The acoustic values given are only valid under the measurement conditions listed and may vary depending on the installation situation. With any deviation to the standard setup, the specific values have to be checked and reviewed once installed or fitted!

MED SERIES

CHARACTERISTICS CHART

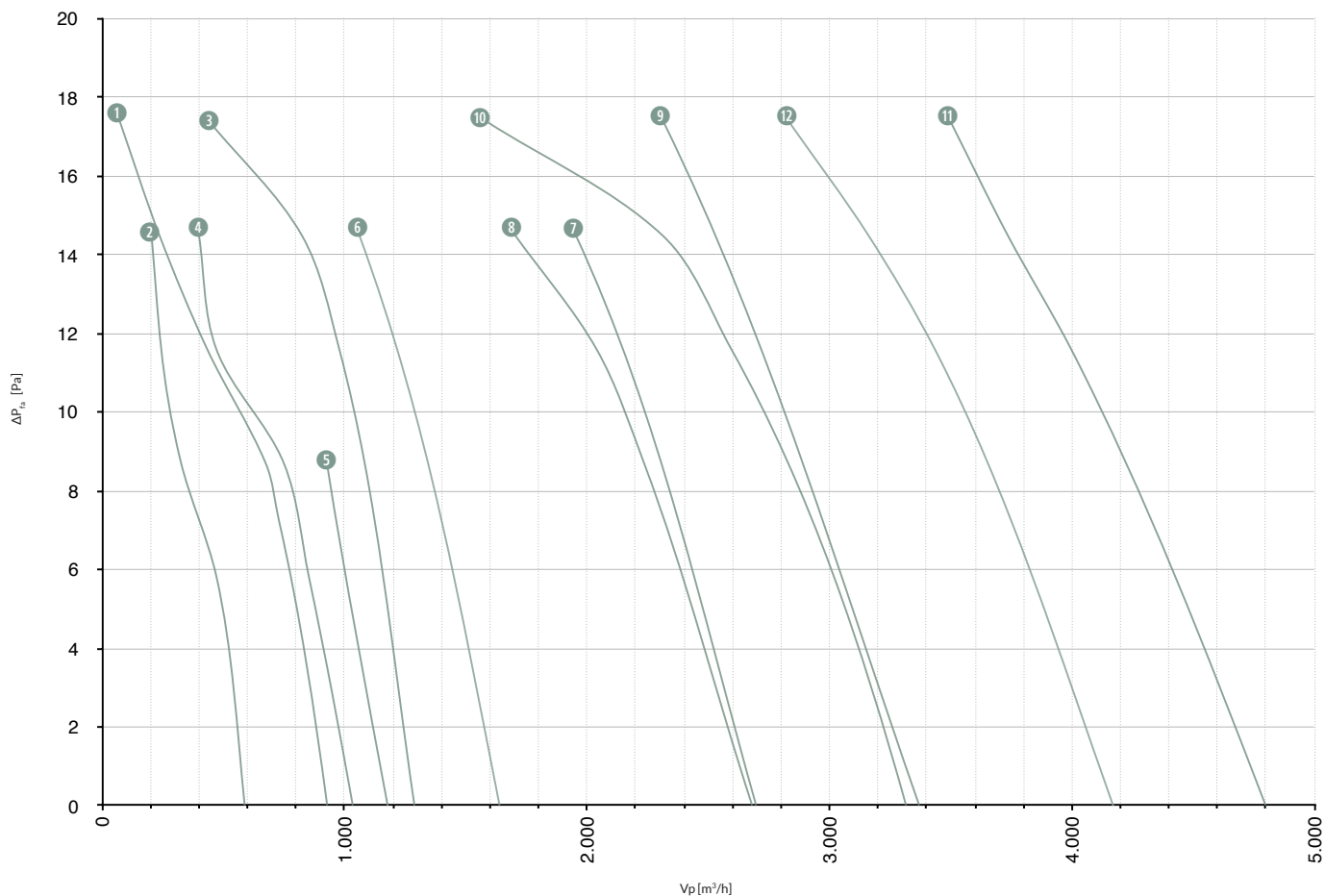

TECHNICAL DATA

		f (Hz)	P1 (hp)	U (V)	I (A)	n (min ⁻¹)	cos φ	C _B (μF)	dB(A)	lbs	T _i (°F)
MED2-025-A025E2UL-BBC	①	60	0.17	240 V	0.55	2391	0.98	3	60	5.5	-22°F/+140°F
MED2-025-A025E4UL-BBC	②	60	0.094	240 V	0.29	1674	0.99	2	55	5.5	-22°F/+140°F
MED2-030-A035E2UL-BBC	③	60	0.28	240 V	0.91	2095	0.95	4	62	6.6	-22°F/+140°F
MED2-030-A035E4UL-BBC	④	60	0.12	240 V	0.40	1619	0.94	3	60	6.6	-22°F/+140°F
MED2-031-A035E4UL-BBC	⑤	60	0.19	240 V	0.62	1650	0.93	4	61	7.7	-22°F/+140°F
MED2-035-B034E4UL-BBC	⑥	60	0.24	240 V	0.78	1664	0.95	4	65	11	-22°F/+140°F
MED2-040-B047D4UL-BBC	⑦	60	0.39	460 V	0.75	1615	0.49	-	63	13.2	-22°F/+140°F
MED2-040-B047E4UL-BBC	⑧	60	0.39	240 V	1.28	1594	0.94	6	68	13.2	-22°F/+140°F
MED2-045-B060D4UL-BBC	⑨	60	0.49	460 V	0.63	1601	0.73	-	70	17.6	-22°F/+140°F
MED2-045-B060E4UL-BBC	⑩	60	0.52	240 V	1.71	1553	0.94	8	70	17.6	-22°F/+140°F
MED2-050-C035D4UL-BBC	⑪	60	0.65	460 V	0.84	1625	0.73	-	72	19.8	-22°F/+122°F
MED2-050-C035E4UL-BBC	⑫	60	0.69	240 V	2.26	1562	0.95	10	72	19.8	-22°F/+140°F

Copyright Sovatec Produktions GmbH. This data sheet shows a technical overview of our products. Please contact us if more detailed information is needed. As we are constantly improving our products, their characteristics, dimensions and weights may also change, although we do our best to incorporate these changes continually. The information in this data sheet is intended to be used as a first general guideline only. Sovatec assumes no liability for any information therein, any errors, omissions, misprints, nor any direct or indirect damages, losses or costs resulting therefrom. The acoustic values given are only valid under the measurement conditions listed and may vary depending on the installation situation. With any deviation to the standard setup, the specific values have to be checked and reviewed once installed or fitted!

SALES CONTACTS

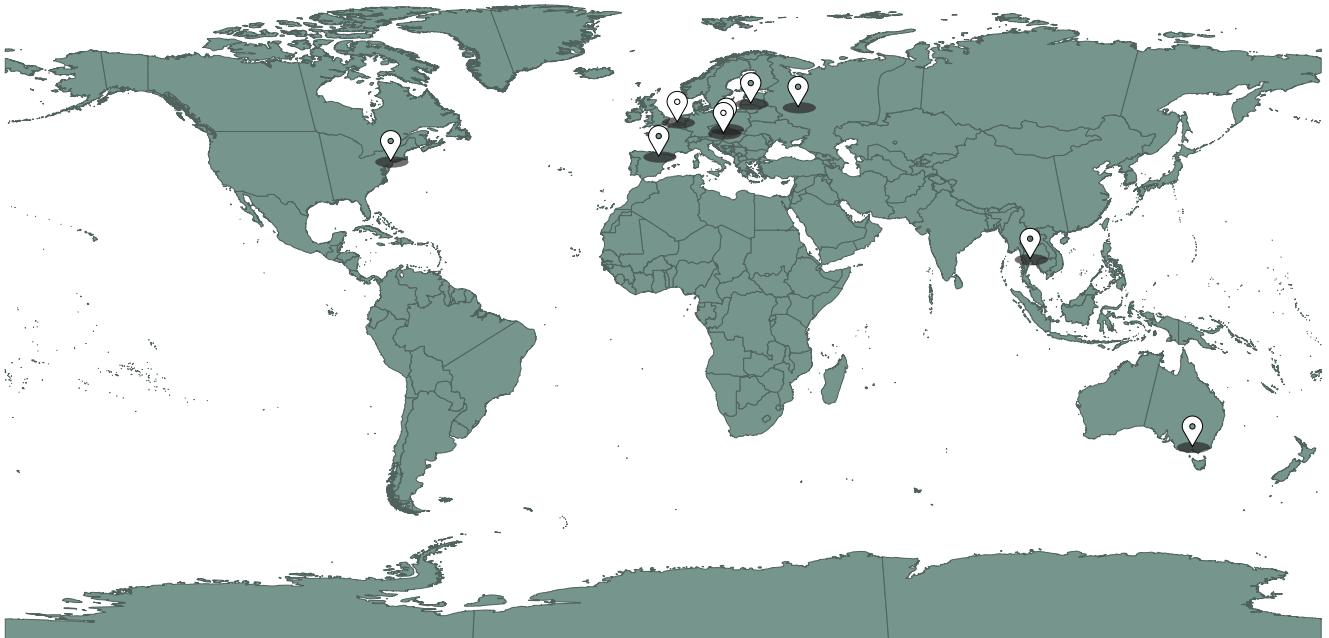

AUSTRIA

Aufeldgasse 37-39
3400 Klosterneuburg

NETHERLANDS

Kanaalpark 16
4553EC Philippine

CZECH REPUBLIC

Druzstevni 9
742 35 Odry

LATVIA

DBF Technic, SIA
LV 1004 Bauskas 20, Riga

RUSSIA

Ostrovityanova str. 53k3-71
Moscow 117342

THAILAND

Kalapaprueg Road
Metropark 194/193
10160 BANGKOK

USA

Tecmere Inc.
160 Meister Avenue
Branchburg, NJ 08876

SPAIN

San Vicente de Paul, 44
50001 Zaragoza

AUSTRALIA

4/15 Bentley street
Williamstown ,Vic 3016

CONTACT

Email: support@sovatec.com

Web: www.sovatec.com

Phone: (+43) 2243 208 060